

VIA™ ASSISTANCE TOWER



VIA™ SERIES ASSISTANCE TOWER

VIA™ ASSISTANCE TOWER IS AN IDEAL SOLUTION FOR LOCATIONS WITH FOOT TRAFFIC FOR VISITORS AND STAFF. THE ALWAYS LIT BLUE LED LIGHT BAND PROVIDES HIGH VISIBILITY AND GIVES PEDESTRIANS A SENSE OF SECURITY. AT THE PUSH OF A BUTTON, THE BLUE LED LIGHT BAND BEGINS TO FLASH DRAWING IMMEDIATE ATTENTION TO THE TOWER.

FEATURES

- Highly visible, tower mount form factor
- Includes a VOIP-200 Series Compact IP Call Station
- This stylized tower includes a blue LED light band and is available with card reader and push plate switch options
- Blue LED light band flashes to indicate when call station is activated
- 16 GA, steel construction
- 12 GA, 316 stainless steel front panels
- ADA-compliant
- Rated NEMA 3R
- Vandal-resistant with coating designed to resist extreme weather conditions
- Attractive assistance solution with high visibility LED light band.
- Available design options for custom signage, instructions, and color
- Ideal solution for locations with pedestrian traffic



GENERAL SPECIFICATIONS	AC-MT Series
Construction:	Tower Mount: 16GA (0.06") steel Front Panels: 12GA (0.105") 316 stainless steel Tower is rated NEMA 3R Call station is rated IP66
Dimensions (W x H x D):	9.12 x 83.86 x 4.03 in. (231.6 x 2130 x 102.3 mm)
Weight:	55 lbs. (25 kg)
Colors:	Black with stainless steel front panels is standard. Custom paint colors available.
Lighting:	LED Light Band: Ultra-bright blue LEDs that flash when activated by call station
Mounting:	Mounts to concrete foundation
Power:	24VDC (110VAC supported with optional power supply)

ACCESSORY OPTIONS



AVM-1
IP Video Attendant Station



Touchless Push Plate Switch



Card Reader



Card Reader with Keypad



Push Plate Switch



VOIP-200C



VOIP 200C3



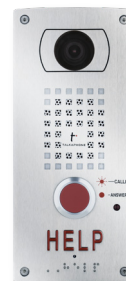

VOIP-200H



VOIP-200H3

ORDERING INFORMATION

Base Model	Mount Type	Configuration Number	VOIP-200 Series Model	Card Reader Type	Touchless Push Plate
AC-	MT- Mounting Tower	1	Call station only	C Includes VOIP-200C	-TL With touchless push plate
		2	Call station with card reader	C3 Includes VOIP-200C3	*Leave blank for no touchless push plate
		3	Call station with push plate	H Includes VOIP-200H	
		4	Call station with card reader and push plate	H3 Includes VOIP-200H3	
		5	Call station with 36-inch push plate		
Example: AC-MT-4H3					
AC-	MT-	4	H3		

	VIA™ Series Card Reader	VIA™ Series Card Reader with Keypad
		
HID Part Number	900PTNNEK00000	921PTNNEK00000
HID Base Model	RP10	RPK40
Communications Interface	Wiegand	Wiegand
125 kHz Credential Compatibility (multiCLASS only)	HID Prox, AWID, EM4102	
13.56 MHz Credential Compatibility	iCLASS, iCLASS SE, iCLASS Seos, MIFARE Classic (CSN), MIFARE DESFire EV1 (CSN)	
Panel Connection	Pigtail - 18" (0.45m)	Pigtail - 18" (0.45m)
Keypad Output	-	8-bit burst

All specifications are subject to change without notice.

DIMENSIONAL DIAGRAMS

All dimensions are in inches and are provided for reference only.

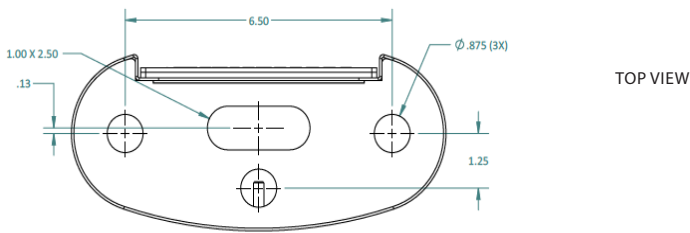
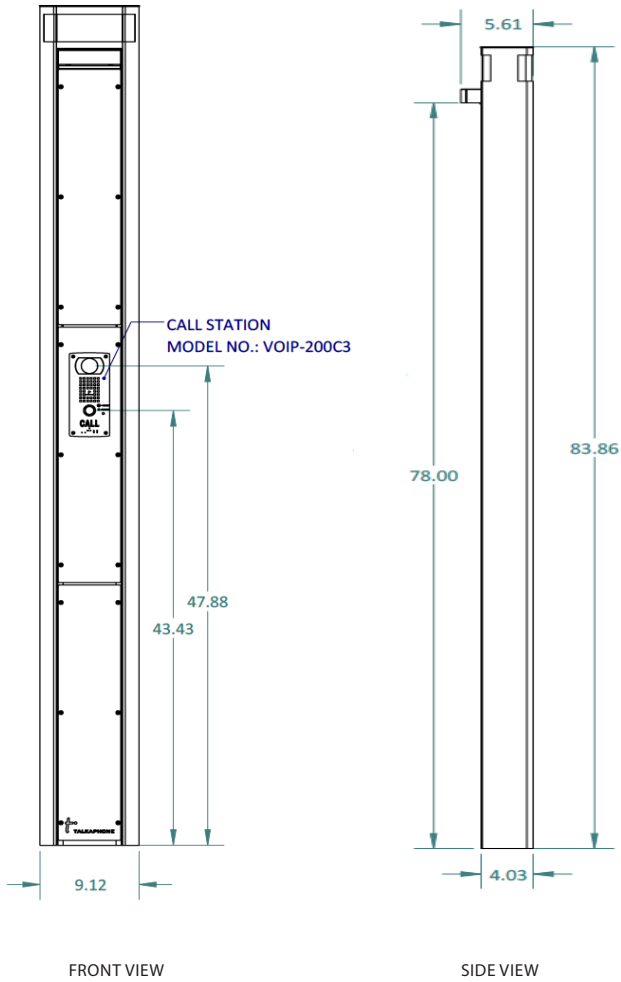

THE LEADERS IN SECURITY AND LIFE SAFETY COMMUNICATIONS

7530 North Natchez Avenue
Niles, Illinois 60714

Tel: 773-539-1100
Email: info@talkaphone.com
Web: www.talkaphone.com

ACCESSORIES:

Video Attendant Station:

Model: AVM-1:

- Displays video from IP call station with IP camera for monitoring access to facilities.
- Multiple call stations can be connected to multiple master stations to create a robust access control system. AVM-1 can support up to 30 call stations.

TERMS OF USE AND LIMITED WARRANTY

Talk-A-Phone, LLC warrants Talk-A-Phone Emergency Phone, Call Station, Wide-Area Emergency Broadcast System, and Area of Rescue equipment against any defects in material and workmanship, under normal use, for a period of twenty-four (24) months from date of installation, provided that Talk-A-Phone receives a completed "Installation Certification" certifying the date on which the system has been installed. An "Installation Certification" card is enclosed with every unit. In the event that no "Installation Certification" is received by Talk-A-Phone, the twenty-four (24) months will commence on the date of shipment by Talk-A-Phone. Warranty period for the metal elements of models in the GP Series Pedestals, MT Series Towers, MTE Series Towers, MT/R Series Towers, PM Series Pedestals, SM Series Surface Mounts, VIA™ Series Mounts, and WM Series Wall Mounts is five (5) years, under the same terms and conditions. Warranty period for Intercommunication Products is twelve (12) months, under the same terms and conditions.

THIS WARRANTY GIVES YOU SPECIFIC LEGAL RIGHTS AND YOU MAY ALSO HAVE OTHER RIGHTS WHICH VARY FROM STATE TO STATE.

Copyright 2019 Talk-A-Phone, LLC

All Rights Reserved